

7

- ENG. MGR
- ENG
- PURCH.
- MKTG.
- PLT. MGR.
- COST
- PROD.
- INSP
- GLAZE
- BUSHING
- MAKING
- SHIP
- ASSEM
- MODEL
- MACH.
- 45
- TOOLING
- CER LAB
- EL LAB
- Q. A.

TOP INSERT  
 (4) 3/8"-16 NC ON 2.0" BC  
 1/2" FULL THREAD  
 (1) 5/8"-11 NC  
 3/4" FULL THREAD

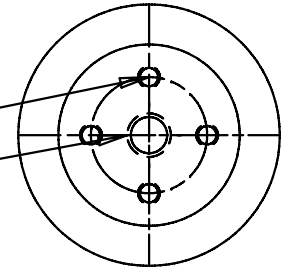

MECHANICAL VALUES

CANTILEVER STRENGTH	LB	1,250
TENSILE STRENGTH	LB	3,000
TORSION STRENGTH	IN-LB	3,500
COMPRESSION STRENGTH	LB	20,000

ELECTRICAL VALUES

NEMA, VOLTAGE RATING	kV	13.2
60 HERTZ WITHSTAND-DRY	kV	36
60 HERTZ WITHSTAND-DEW	kV	26
IMPULSE WITHSTAND	kV	95

PACKING INFORMATION

NET WEIGHT , PER 100	LB	850
----------------------	----	-----

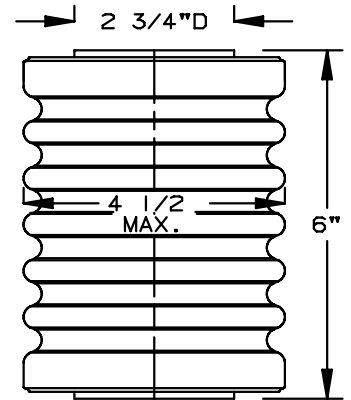

BOTTOM INSERT  
 (4) 3/8"-16 NC ON 2.0" BC  
 1/2" FULL THREAD  
 (1) 3/4"-10 NC  
 7/8" FULL THREAD

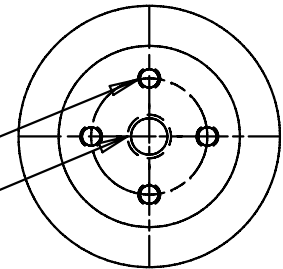

THIS DRAWING IS THE PROPERTY OF  
 VICTOR INSULATORS, INC. AND CONTAINS  
 PROPRIETARY AND CONFIDENTIAL INFORMATION  
 WHICH MUST NOT BE REPLICATED, COPIED,  
 OR DISCLOSED OTHER THAN AS EXPRESSLY  
 AUTHORIZED BY VICTOR INSULATORS, INC.

APPROVED  
 By A. E. Schwalm at 11:23 am, Nov 29, 2007

CORRECTED THREAD DEPTH	06-09-07	TM	A
06-09-07		TM	



Victor Insulators, Inc.

280 MAPLE AVENUE  
 VICTOR, NEW YORK 14564  
 TELEPHONE: (585)924-2127

5752