

**SUSPENSION INSULATOR**

ANSI CLASS 52-10H

CAT NO. VI 52-10H TG

DIMENSIONS:

LEAKAGE DISTANCE IN[mm] 11[280]

TOUGHENED GLASS

MECHANICAL VALUES:

M&E STRENGTH LB[kN] 40,000[178]  
 IMPACT STRENGTH IN-LB[N-m] 400[10]  
 TENSION PROOF LB[kN] 20,000[89]

ELECTRICAL VALUES:

60 HERTZ FLASHOVER-DRY kV 80  
 60 HERTZ FLASHOVER-WET kV 50  
 IMPULSE FLASHOVER-POS kV 125  
 IMPULSE FLASHOVER-NEG kV 130  
 LOW FREQUENCY PUNCTURE kV 110

RADIO INFLUENCE VOLTAGE DATA:

60 HERTZ TEST VOLTAGE TO GROUND kV 10  
 MAXIMUM R.I.V. @ 1000 kHz μV 50

PACKAGING INFORMATION:

NET WEIGHT, LB[kg] 20[9]  
 PACKED WEIGHT LB[kg] 22[10]

- 1 ENG. MGR
- 2 ENG
- PURCH.
- 1 MKTG.
- PLT.MGR.
- COST
- PRD.
- INSP
- GLAZE
- BUSHING
- MAKING
- SHIP
- ASSEM
- MODEL
- MACH.
- 45
- TOOLING
- CER LAB
- 1 EL LAB
- 1 E.MEDIA

THIS DRAWING IS THE PROPERTY OF VICTOR INSULATORS, INC. AND CONTAINS PROPRIETARY AND CONFIDENTIAL INFORMATION WHICH MUST NOT BE DUPLICATED, USED, OR DISCLOSED OTHER THAN AS EXPRESSLY AUTHORIZED BY VICTOR INSULATORS, INC.

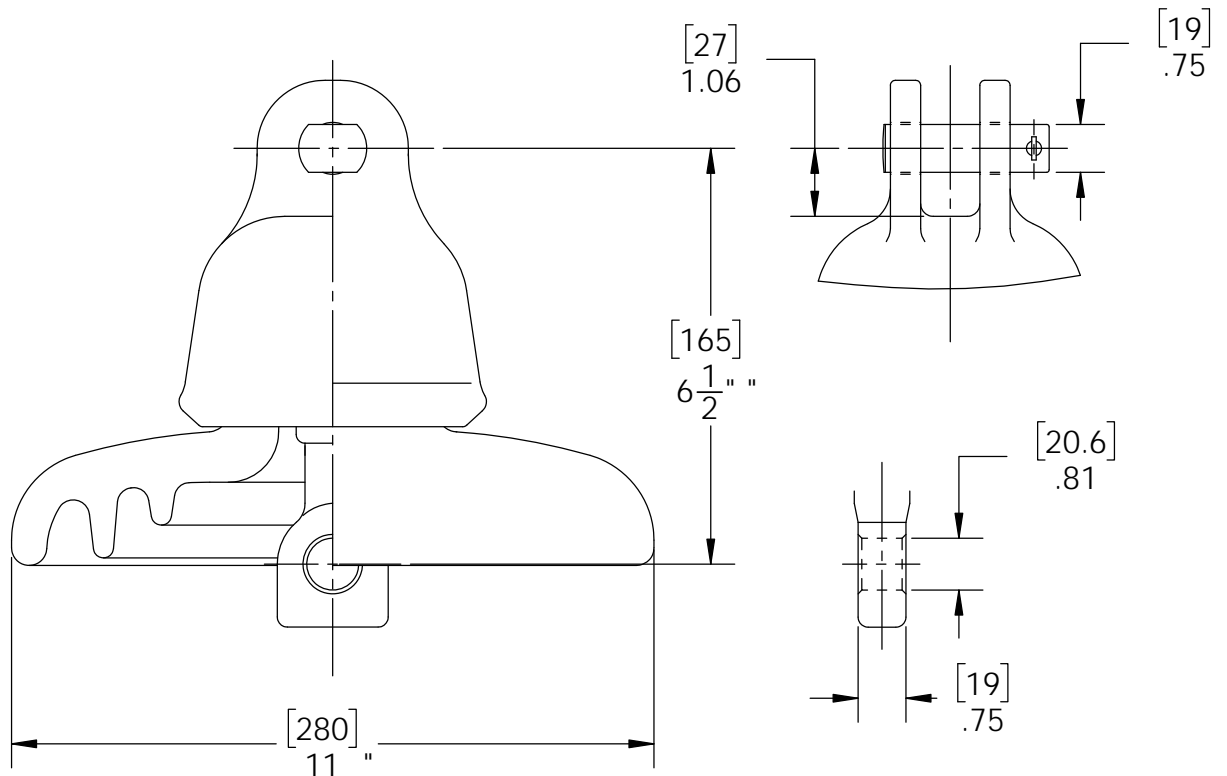

**APPROVED**  
 By A. E. Schwalm at 10:32 am, Apr 10, 2017



**Victor Insulators, Inc.**  
 280 Maple Avenue  
 Victor, New York 14564  
 Telephone: (585)924-2127  
 www.victorinsulators.com

**VI 52-10H**  
**TG**

04-07-17

TM