

30

STATION POST	
CAT. NO. 1723	
230kV	900 kV BIL
TR NO. 304	

2 ENG.
1 MKTG.
1 COST
1 SHIP.
1 ASSEM.
1 INSP
1 E.MEDIA

DIMENSIONS

LEAKAGE DISTANCE IN 165

MECHANICAL VALUES

CANTILEVER STRENGTH	LB	950
TENSILE STRENGTH	LB	20,000
TORSION STRENGTH	IN-LB	40,000
COMPRESSION STRENGTH	LB	60,000

ELECTRICAL VALUES

60 HERTZ WITHSTAND-WET	kV	385
IMPULSE FLASHOVER-POS.	kV	1,010
IMPULSE WITHSTAND	kV	900

RADIO INFLUENCE VOLTAGE DATA

60 HERTZ TEST VOLTAGE TO GND.	kV	146
MAXIMUM RIV @ 1000 kHz	μV	500

PACKING INFORMATION

NET WEIGHT ,EACH	LB	230
PACKED WEIGHT ,EACH	LB	250
NO. IN STANDARD PACKAGE		1/2

4 HOLES EACH ON END
5/8-11+.015 ON 5" B.C.

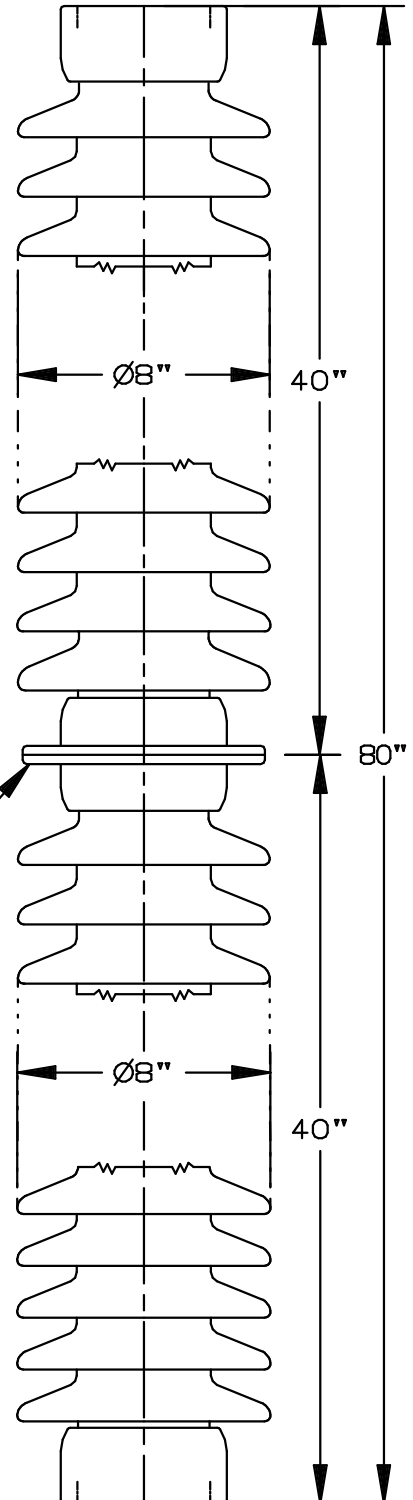
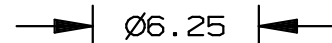

4 HOLES .71
ON 7 7/8" B.C.

THIS DRAWING IS THE PROPERTY OF
VICTOR INSULATORS, INC. AND
CONTAINS PROPRIETARY AND CONFIDENTIAL
INFORMATION WHICH MUST NOT BE DUPLICATED,
USED, OR DISCLOSED OTHER THAN
AS EXPRESSLY AUTHORIZED BY
VICTOR INSULATORS, INC.

APPROVED
By A. E. Schwalm at 5:36 pm, Mar 13, 2014



Victor Insulators, Inc.

280 MAPLE AVENUE
VICTOR, NEW YORK 14564
TELEPHONE: (585)924-2127

1723

03-13-14

TM