

STATION POST

CAT. NO. PSP-210P

34.5 kV 200 kV BIL

ANSI PSP-210P

DIMENSIONS:

LEAKAGE DISTANCE IN 43.9

MECHANICAL VALUES:

CANTILEVER STRENGTH LB 2,000  
 TENSION STRENGTH LB 10,000  
 TORSION STRENGTH IN-LB 6,000  
 COMPRESSION STRENGTH LB 10,000

ELECTRICAL VALUES:

IMPULSE FLASHOVER-POSITIVE kV 225  
 60 HERTZ WITHSTAND-WET kV 80  
 IMPULSE WITHSTAND kV 200

RADIO INFLUENCE VOLTAGE DATA:

60 HERTZ TEST VOLTAGE TO GROUND kV 22  
 MAXIMUM R.I.V. @ 1000 kHz μV 100

- 1 ENG. MGR
- 2 ENG
- PURCH.
- 1 MKTG.
- PLT.MGR.
- COST
- PRD.
- INSP
- GLAZE
- BUSHING
- MAKING
- SHIP
- ASSEM
- MODEL
- MACH.
- 45
- TOOLING
- CER LAB
- 1 EL LAB
- 1 E.MEDIA

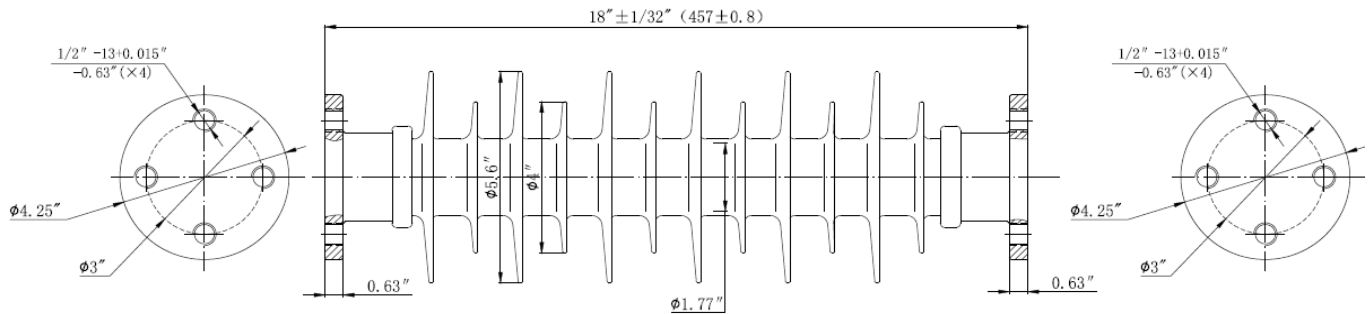

THIS DRAWING IS THE PROPERTY OF VICTOR INSULATORS, INC. AND CONTAINS PROPRIETARY AND CONFIDENTIAL INFORMATION WHICH MUST NOT BE DUPLICATED, USED, OR DISCLOSED OTHER THAN AS EXPRESSLY AUTHORIZED BY VICTOR INSULATORS, INC.

**APPROVED**  
 By A. E. Schwalm at 1:32 pm, Nov 06, 2017

11-06-17	TM	 <b>Victor Insulators, Inc.</b> 280 Maple Avenue Victor, New York 14564 Telephone: (585)924-2127 www.victorinsulators.com	PSP-210P
04-05-16	TM		
10-03-12	TM		