

STATION POST

CAT. NO. PSP-216P

69 kV 350 kV BIL

ANSI PSP-216P

DIMENSIONS:

LEAKAGE DISTANCE IN 77

MECHANICAL VALUES:

CANTILEVER STRENGTH LB 1,500
 TENSION STRENGTH LB 16,000
 TORSION STRENGTH IN-LB 6,000
 COMPRESSION STRENGTH LB 16,000

ELECTRICAL VALUES:

IMPULSE FLASHOVER-POSITIVE kV 390
 60 HERTZ WITHSTAND-WET kV 145
 IMPULSE WITHSTAND kV 350

RADIO INFLUENCE VOLTAGE DATA:

60 HERTZ TEST VOLTAGE TO GROUND kV 44
 MAXIMUM R.I.V. @ 1000 kHz μ V 200

- 1 ENG. MGR
- 2 ENG
- PURCH.
- 1 MKTG.
- PLT.MGR.
- COST
- PRD.
- INSP
- GLAZE
- BUSHING
- MAKING
- SHIP
- ASSEM
- MODEL
- MACH.
- 45
- TOOLING
- CER LAB
- 1 EL LAB
- 1 E.MEDIA

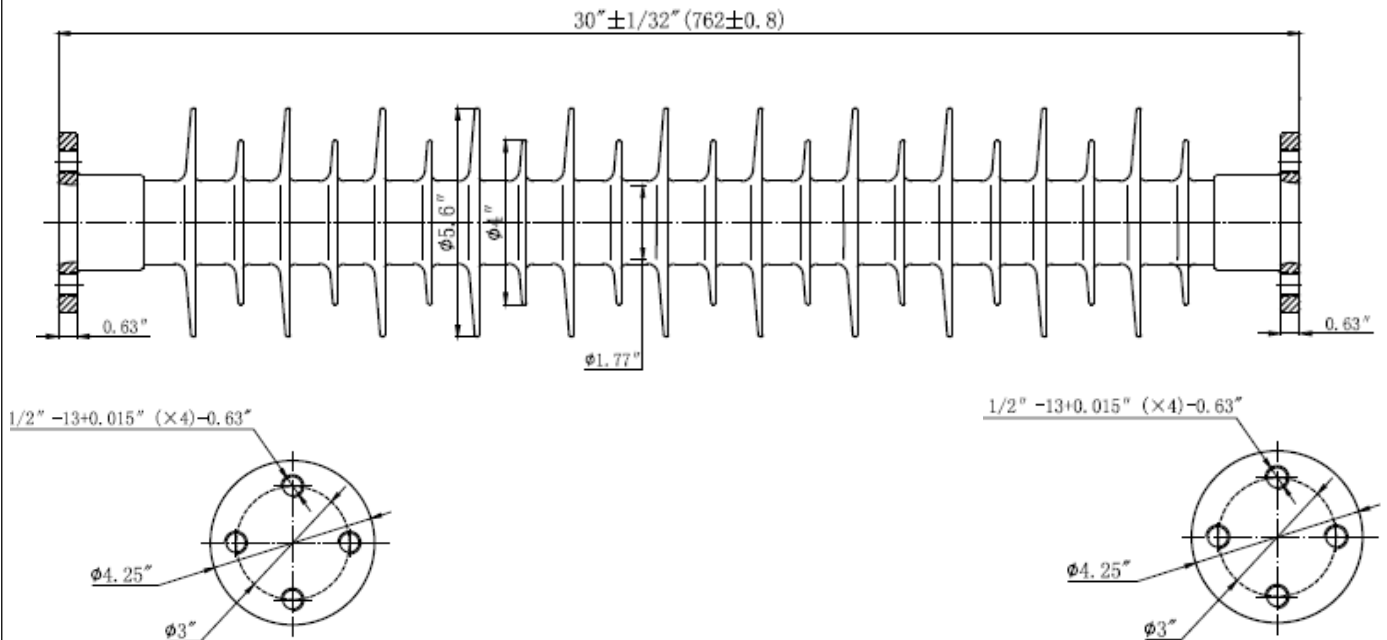

THIS DRAWING IS THE PROPERTY OF VICTOR INSULATORS, INC. AND CONTAINS PROPRIETARY AND CONFIDENTIAL INFORMATION WHICH MUST NOT BE DUPLICATED, USED, OR DISCLOSED OTHER THAN AS EXPRESSLY AUTHORIZED BY VICTOR INSULATORS, INC.

APPROVED
 By A. E. Schwab at 9:36 am, Apr 06, 2016

04-05-16		TM	
06-19-15		TM	
06-14-12		TM	



Victor Insulators, Inc.
 280 Maple Avenue
 Victor, New York 14564
 Telephone: (585)924-2127
 www.victorinsulators.com

PSP-216P

PSP-216P