

POLYMER (SILICONE) INSULATOR

46 kV

DS-46

7

ENG. MGR.

2 ENG.

PURCH.

1 MKTG.

PLT. MGR.

CDST

1 PRDD.

INSP.

GLAZE

BUSHING

MAKING

1 SHIP.

1 ASSEM.

MODEL

MACH.

45

TOOLING

CER. LAB.

1 EL. LAB.

Q.A.

TECHNICAL SPECIFICATIONS:

TYPICAL APPLICATION VOLTAGE	46	kV
60 HERTZ FLASHOVER - DRY	205	kV
60 HERTZ FLASHOVER - WET	165	kV
IMPULSE FLASHOVER POSITIVE	290	kV

RADIO INFULUENCE VOLTAGE:	30	kV
MAX. RIV @1000 kHz, μ V	10	μ V

LEAKAGE DISTANCE	42.9	IN	1091	mm
DRY ARCING DISTANCE	18.6	IN	472	mm
SPECIFIED MECHANICAL LOAD	15,000	LBS	70	kN
TORSIONAL LOAD	415	IN-LBS	47	Nm
NUMBER OF SHEDS	12			

THIS DRAWING IS THE PROPERTY OF VICTOR INSULATORS, INC. AND CONTAINS PROPRIETARY AND CONFIDENTIAL INFORMATION WHICH MUST NOT BE DUPLICATED, USED, OR DISCLOSED OTHER THAN AS EXPRESSLY AUTHORIZED BY VICTOR INSULATORS, INC.

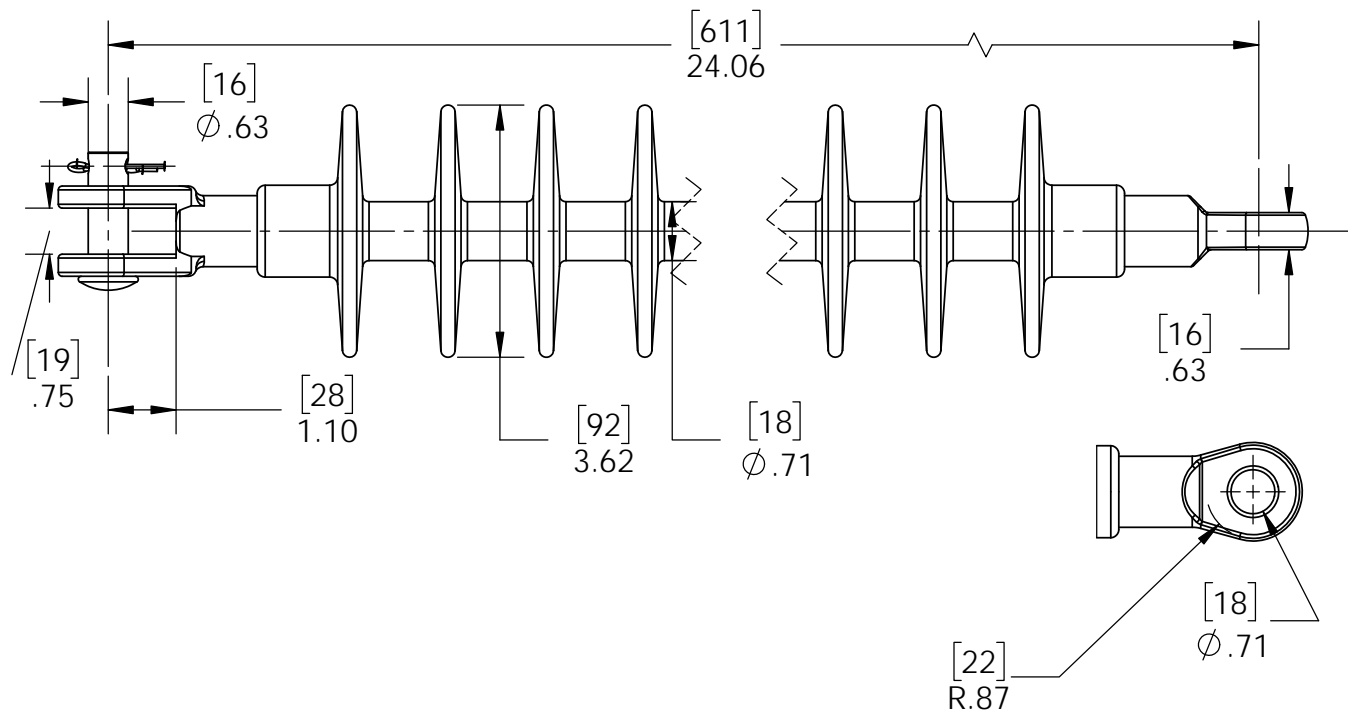

APPROVED
By A. E. Schwalm at 2:35 pm, Feb 05, 2019

01-30-19		TM	 Victor Insulators, Inc. 280 Maple Avenue Victor, New York 14564 Telephone: (585)924-2127 www.victorinsulators.com	<h1>8246</h1>
06-07-16		TM		
09-30-15		TM		

PART NO. 8246